

FA01 MAINTENANCE OPERATIONS FA01A MAINTENANCE BAY 01.01 MAINTENANCE MODULES	FA01D COMPONENT REPAIR SHOPS 01.71 POWER PLANT SHOP 01.72 POWER TRAIN SHOP 01.73 STRUCTURAL REPAIR SHOP 01.74 COMPOSITE SHOP 01.75 BLADE SHOP 01.76 PPE SUITE 01.77 PNEUDRULICS REPAIR SHOP 01.78 ELECTRICAL / AVIONICS REPAIR SHOP 01.79 ALSE SHOP / LOCKERS 01.80 AIRCRAFT MOUNTED SYSTEMS VAULT 01.81 NDI	02.08 FLIGHT OPS 02.09 FLIGHT OPS OFC 02.10 FLIGHT OPS STOR	FA03B BUILDING SUPPORT 90.01 PRIMARY ELECTRICAL 90.02 PRIMARY MECHANICAL 90.03 TELECOMM ENTRY (TER) 90.04 PRIMARY FIRE PROTECTION 90.05 COMPRESSOR 90.06 BRANCH ELEC 90.07 ZONE MECHANICAL 90.08 TR 90.09 SIPR 90.10 LIS 90.11 ELEV EQ
FA01B SHOP ADMIN 01.02 AIRF RPR HQ 01.03 COMP RPR HQ 01.06 QC WORKROOM 01.07 QC OFFICE 01.08 PC WORKROOM 01.09 PC OFFICE 01.11 LIS SERVER 01.12 LARS 01.13 H-60 SUPER 01.15 H-47 SUPER 01.17 MAINTENANCE TEST PILOT WORKROOM	FA01E AIRCRAFT PARTS STORAGE 01.91 TECH SUPPLY / OFFICE	FA02C COMPANY HQ 02.21 FLIGHT CO HQ 02.22 MAINT CO HQ 02.23 FLIGHT CO READINESS MODULE 02.24 MAINT CO READINESS MODULE 02.25 COMBINED WEAPONS VAULT	FA03C CIRCULATION 95.01 SERVICE CORR 95.02 VEST
FA01C MAINTENANCE SUPPORT 01.51 H-60 REPAIR SECTION WORKROOM 01.53 H-47 REPAIR SECTION WORKROOM 01.55 SPECIAL TOOLS 01.56 CREW CHIEF WORKROOM	FA02 AVIATION UNIT OPERATIONS FA02B FLIGHT OPS 02.02 FLIGHT PLANNING 02.03 SECURE FLIGHT PLANNING 02.05 PILOT BRIEFING ROOM 02.06 PILOT BRIEFING STORAGE	FA03 NET-TO-GROSS AREA FA03A COMMON AREAS 80.01 BREAK ROOM 80.02 LACTATION 80.03 JAN 80.04 VENDING / RECYCLE 80.05 LATRINES / SHOWERS 80.06 LATRINES 80.07 TLT/SHWR 80.08 FAC STOR 80.09 TLT	FA03D VERTICAL CIRCULATION 96.01 STAIR 96.02 ELEV

NOTES:
 1. THE ARMY STANDARDS FOR AVIATION MAINTENANCE HANGAR COMPLEX ARE FINAL AUTHORITY ON TOTAL ALLOWABLE GROSS SQUARE FOOTAGE OF FACILITY. COORDINATE WITH COS TO DETERMINE THIS ALLOWANCE BASED ON ARMY STANDARDS AND SPECIFIC ORGANIZATION MANNING DOCUMENT (TOE, TDA).
 2. NOTIONAL ADJACENCY DIAGRAM QUANTITY OF 7 AIRCRAFT MODULES IS USED FOR ILLUSTRATIVE PURPOSES ONLY. ORGANIZATION-ASSIGNED AIRCRAFT AND PERSONNEL WILL IMPACT TOTAL FACILITY SIZE AND SPACE PROGRAM.
 3. DIAGRAM ILLUSTRATES TYPICAL SPACES REQUIRED FOR ROTARY WING / TILT-ROTOR FLIGHT ORGANIZATIONS. FOR FIXED WING FLIGHT ORGANIZATIONS, VALIDATE PROGRAM WITH COS.

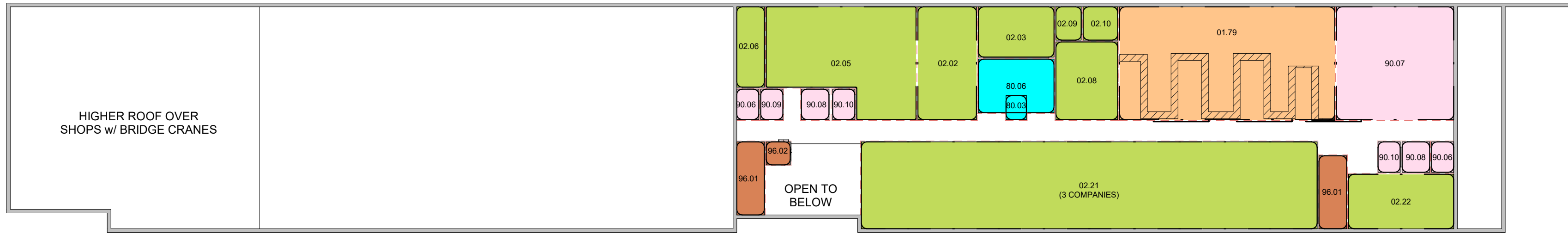

2ND FLOOR



1ST FLOOR

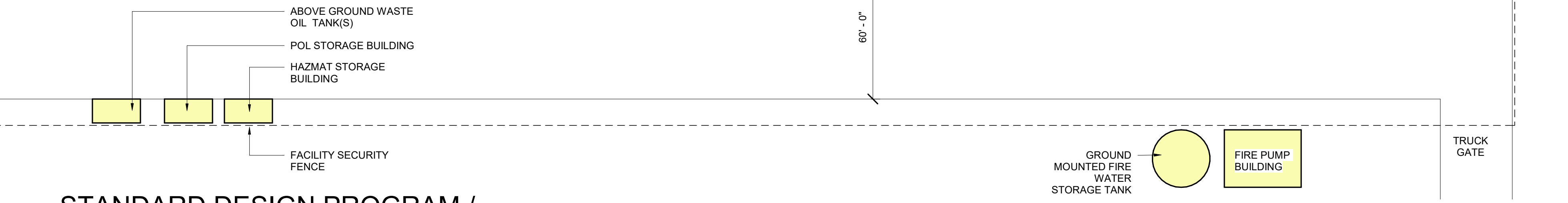

1 STANDARD DESIGN PROGRAM / ADJACENCY DIAGRAM
 1/32" = 1'-0"

TOE / TDA FLIGHT ORGANIZATION

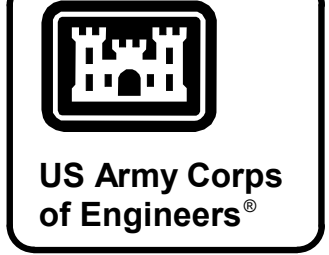

ISSUE DATE:	APRIL 2026
DESIGNED BY:	BUSH
DRAWN BY:	BUSH
CHECKED BY:	BUSH
SUBMITTED BY:	BUSH
SIZE:	ANSI D
FILE NAME:	
PROJECT NUMBER:	
CONTRACT NO.:	
SOLICITATION NO.:	
DATE	
MARK	
DESCRIPTION	

U.S. ARMY CORPS OF ENGINEERS
 STANDARD DESIGN PROGRAM / ADJACENCY DIAGRAM

SHEET ID
A101

FA01 MAINTENANCE OPERATIONS		FA01D COMPONENT REPAIR SHOPS		FA03 NET-TO-GROSS AREA	
FA01A MAINTENANCE BAY		FA01E AIRCRAFT PARTS STORAGE		FA03A COMMON AREAS	
01.01	MAINTENANCE MODULES	01.71	POWER PLANT SHOP	80.01	BREAK ROOM
FA01B SHOP ADMIN		01.72	POWER TRAIN SHOP	80.02	LACTATION
01.02	AIRF RPR HQ	01.73	STRUCTURAL REPAIR SHOP	80.03	JAN
01.03	COMP RPR HQ	01.74	COMPOSITE SHOP	80.04	RECYCLE
01.04	AVIO RPR HQ	01.75	BLADE SHOP	80.05	LATRINES / SHOWERS
01.05	ARMT RPR HQ	01.76	PPE SUITE	80.07	TLT/SHWR
01.06	QC WORKROOM	01.77	PNEUDRULICS REPAIR SHOP	80.08	FAC STOR
01.07	QC OFFICE	01.78	ELECTRICAL REPAIR SHOP	80.09	TLT
01.08	PC WORKROOM	01.79	AVIONICS REPAIR SHOP	FA03B BUILDING SUPPORT	
01.09	PC OFFICE	01.80	AIRCRAFT MOUNTED SYSTEMS VAULT	90.01	PRIMARY ELECTRICAL
01.11	LIS SERVER	01.81	NDI	90.02	PRIMARY MECHANICAL
01.12	H-47 SUPER	01.82	NVG REPAIR SHOP	90.03	TELECOMM ENTRY (TER)
01.13	H-60 SUPER	01.83	MACHINE / WELDING REPAIR SHOP	90.04	PRIMARY FIRE PROTECTION
01.14	H-64 SUPER	01.84	GROUND COMMUNICATIONS REPAIR SHOP	90.05	COMPRESSOR
01.17	MAINTENANCE TEST PILOT WORKROOM	01.85	SYSTEMS / ARMAMENT REPAIR SHOP	90.06	BRANCH ELEC
FA01C MAINTENANCE SUPPORT		FA01E AIRCRAFT PARTS STORAGE		90.07	ZONE MECHANICAL
01.09	POL OFFICE	01.91	TECH SUPPLY / OFFICE	90.08	TR
01.51	H-47 REPAIR SECTION WORKROOM	FA02 AVIATION UNIT OPERATIONS		90.09	SIPR
01.52	H-60 REPAIR SECTION WORKROOM	FA02C COMPANY HQ		90.10	LIS
01.53	H-64 REPAIR SECTION WORKROOM	02.24	MAINT CO READINESS MODULE	90.11	FOAM MIXING
01.55	SPECIAL TOOLS	02.25	COMBINED WEAPONS VAULT	FA03C CIRCULATION	
FA02 COMPANY OPERATIONS ADMIN MODULE		FA02C COMPANY OPERATIONS ADMIN MODULE		95.01	SERVICE CORR
08.01	TRAINING OFFICE / ORDERLY	08.01	TRAINING OFFICE / ORDERLY	95.02	VEST
08.02	COMMANDER	08.02	COMMANDER		
08.03	1ST SERGEANT	08.03	1ST SERGEANT		
08.04	SAFETY	08.04	SAFETY		

NOTES:

- THE ARMY STANDARDS FOR AVIATION MAINTENANCE HANGAR COMPLEX ARE FINAL AUTHORITY ON TOTAL ALLOWABLE GROSS SQUARE FOOTAGE OF FACILITY. COORDINATE WITH COS TO DETERMINE THIS ALLOWANCE BASED ON ARMY STANDARDS AND SPECIFIC ORGANIZATION MANNING DOCUMENT (TOE, TDA).
- NOTIONAL ADJACENCY DIAGRAM QUANTITY OF 7 AIRCRAFT MODULES IS USED FOR ILLUSTRATIVE PURPOSES ONLY. ORGANIZATION-ASSIGNED AIRCRAFT AND PERSONNEL WILL IMPACT TOTAL FACILITY SIZE AND SPACE PROGRAM.
- DIAGRAM ILLUSTRATES TYPICAL SPACES REQUIRED FOR ROTARY WING / TILT-ROTOR FLIGHT ORGANIZATIONS. FOR FIXED WING FLIGHT ORGANIZATIONS, VALIDATE PROGRAM WITH COS.

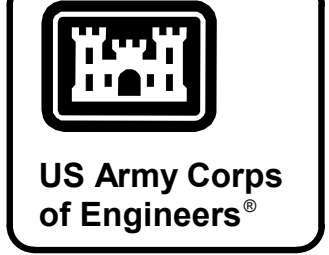

DATE	
MARK	
DESCRIPTION	

DESIGNED BY:	ISSUE DATE:
DRAWN BY:	APRIL 2026
CHECKED BY:	SOLICITATION NO.:
SUBMITTED BY:	CONTRACT NO.:
FILE NAME:	PROJECT NUMBER:
ANSI D	SIZE:

U.S. ARMY CORPS OF ENGINEERS
STANDARD DESIGN PROGRAM / ADJACENCY DIAGRAM

SHEET ID
A102

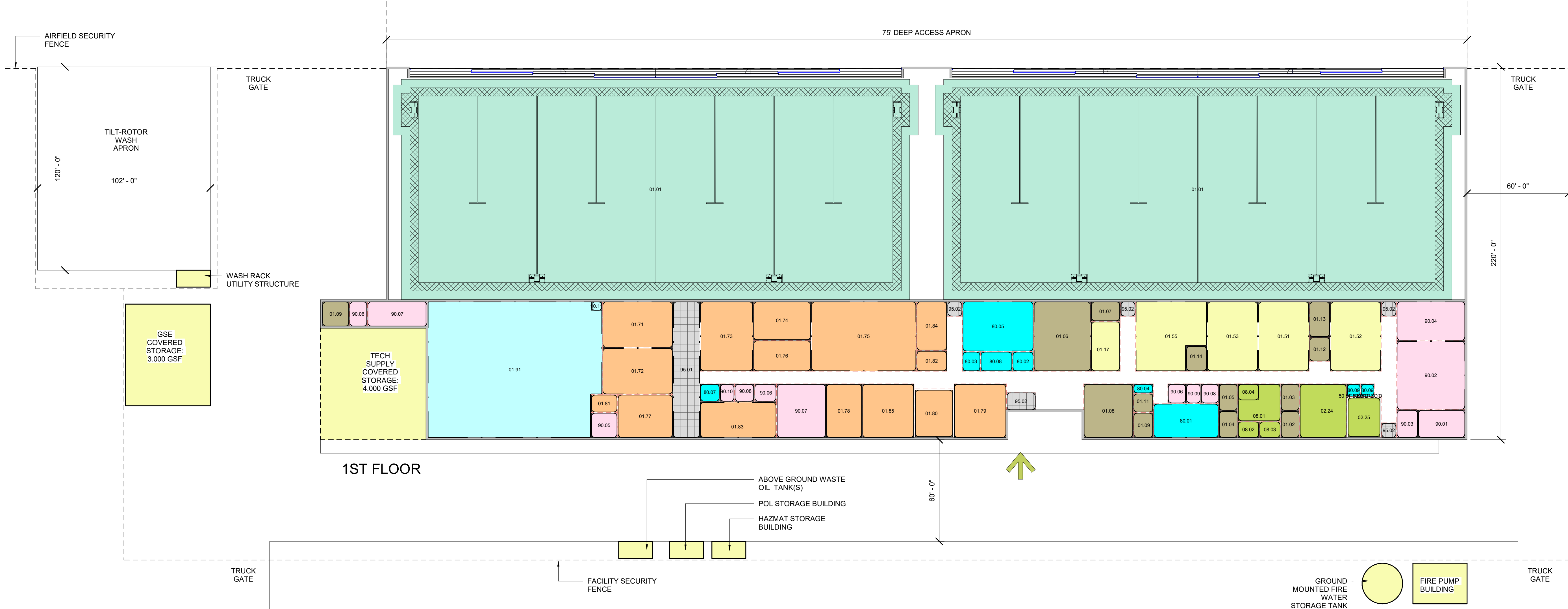

1 STANDARD DESIGN PROGRAM / ADJACENCY DIAGRAM
1/32" = 1'-0"

TOE MAINTENANCE ORGANIZATION

